



**SNOWY MONARO**  
REGIONAL COUNCIL  
*Stronger together Better together*

# **Consultation Summary**

**Michelago Streetscape**

**Concept Design**

**July 2018**

# Concept Design

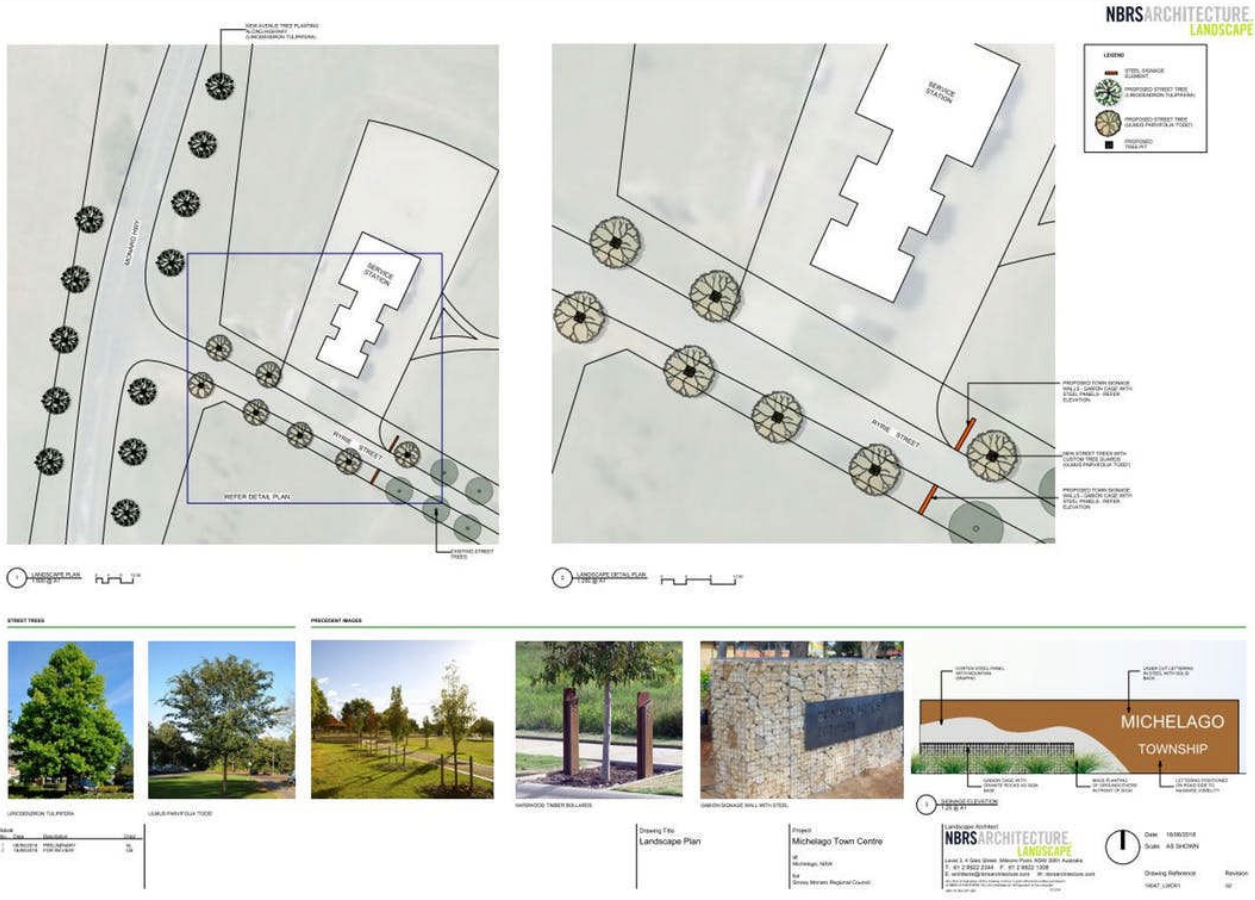

## Summary

Representatives from Snowy Monaro Regional Council attended Michelago Community Hall on Monday 21 May 2018 to present initial sketches and concepts for the upcoming Stronger Communities Fund Major Projects Program (SCFMPP) - Streetscape enhancement project.

This community meeting allowed SMRC to highlight the different features of the proposal and feedback was obtained from the attendees. These concepts were then further developed into the preliminary designs.

The Michelago Streetscape Designs were then released for public consultation via SMRC’s Your Say website on 4 July 2018 and submissions closed on 25 July 2018.

**188 visitors attended the Michelago Streetscape Your Say site during this period.**

**38 submission was made to the survey.**

## Survey results

The survey tool which was included as part of online consultation was completed by a number of visitors to the Your Say website, totalling 20%.

### First impressions and overall satisfaction

The initial question targeted a response to measure first impressions and overall satisfaction towards the Michelago Streetscape design. The results indicate that the design had not met the expectations of the survey participants

On first impressions, what is your overall satisfaction of the Michelago streetscape concept design?

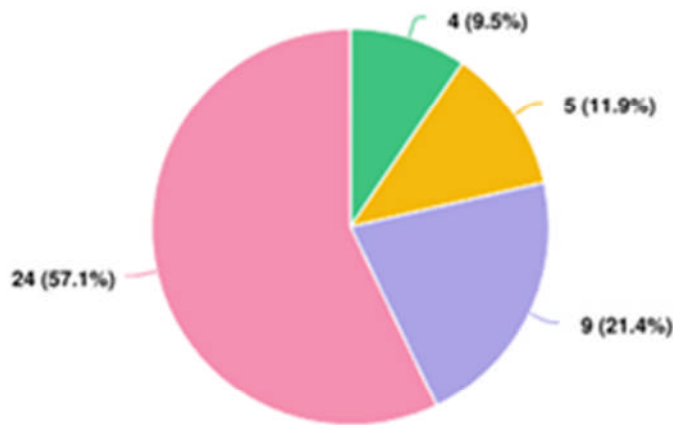

**Question options**

- Excellent
- Good
- Minor changes to improve
- Does not meet my expectations

(42 responses, 0 skipped)

## Theming and style

Survey results indicate that the theming and style component of the project concept designs also did not meet expectations of the survey participants.

Does this proposed design capture the correct theme and style of Michelago?

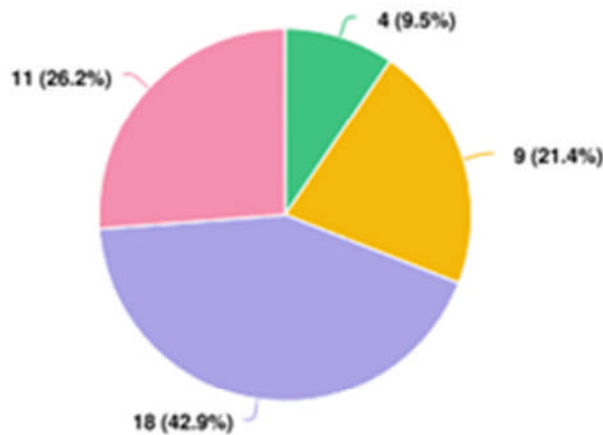

**Question options**

● Strongly agree   
 ● Agree   
 ● Disagree   
 ● Strongly disagree

Optional question (42 responses, 0 skipped)

## Parking and improved access

With limited opportunity in the project scope to improve parking within Michelago, survey results indicate a negative support for the project.

Feedback via the comment section requested that SMRC explore options at the intersection of the Monaro Highway and Ryrie Street.

**Has this design allowed for improved access and parking to visitors and travellers?**

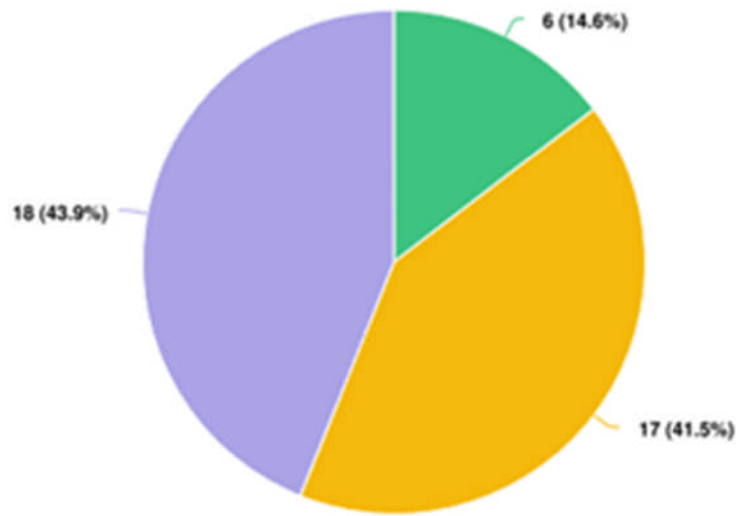

**Question options**

- Agree
- Disagree
- Strongly disagree

Optional question (41 responses, 1 skipped)

**Priorities**

Long vehicle parking was the highest result for the survey. Currently there are limited areas within the village of Michelago to accommodate this result. Street trees and street furniture are within the project scope and budget and these concepts will be further explored into a design.

In order of your preference, what would be highest ranked item that you would consider to be essential for your town or vil...

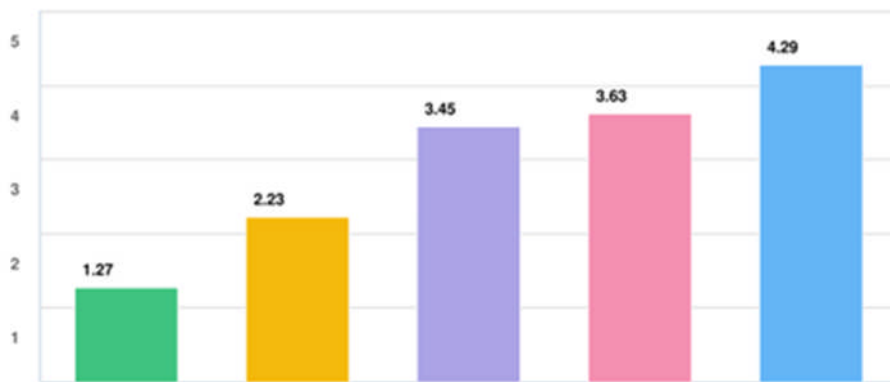

**Question options**

- Improving the entrance ways
- Adding additional features or signage
- Adding additional street furniture
- Street trees
- Long Vehicle Parking

## Open comments

The final question within the survey was open ended and SMRC welcomed the feedback and comments from those who participated. The question asked was:

*Do you wish to add any other comments about the proposed concept design?*

The submissions made have been themed and summarised below. SMRC has offered a response alongside.

Community Response	Snowy Monaro Regional Council Response
Signage	Current SMRC signs are not part of this project, new signs along Ryrie Street have been suggested. Options of suitable design for these signs are being considered.
Service station area	SMRC restricted from funding any improvements to this facility as it is privately owned.
Trees/vegetation	Careful consideration of tree type and placement will be part of the design review as not block vision of traffic along the HWY
Maintaining existing trees	Council has already in place a program of Street tree maintenance
View obstruction	Careful consideration of tree type and placement will be part of the design review as not block vision of traffic along the HWY
Further consultation	Given the results of the survey and a miss alignment of the projects scope, further consultation is recommended.
Infrastructure	
General store signage	Council would recommend any promotional signage of the general store to be submitted as a DA
Re-open Michelago Rd	This section of road not part of the Streetscape Scope of works.
Rest area	A formal rest area at the village entrance will require further consultation with the RMS and is currently not part of this projects scope of works.

## Conclusion

The current proposed Streetscape designs for Michelago have been recommended for further consultation and a revisit to the initial designs may be required before being into design level documents.

Council will seek a formal review of proposed signage at the intersection of Monaro Highway and Ryrie St based on a sketch provided by the community.

SMRC hopes you follow the progress of this exciting project and encourages you to check back on the Your Say website to see progress information and photos, as the project builds momentum towards being constructed.